

TULED SLIM USER MANUAL

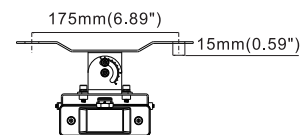

1. The luminaire shall be installed by a qualified electrician and wired in accordance with the latest IEE electrical regulations or the national requirements.
2. No supplied water-proof box, installation should be advised by qualified professional.
3. The external flexible cable can not be replaced. If the cable is damaged, the luminaire should be discarded.

Adjustable ceiling mounting

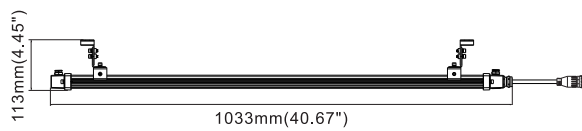
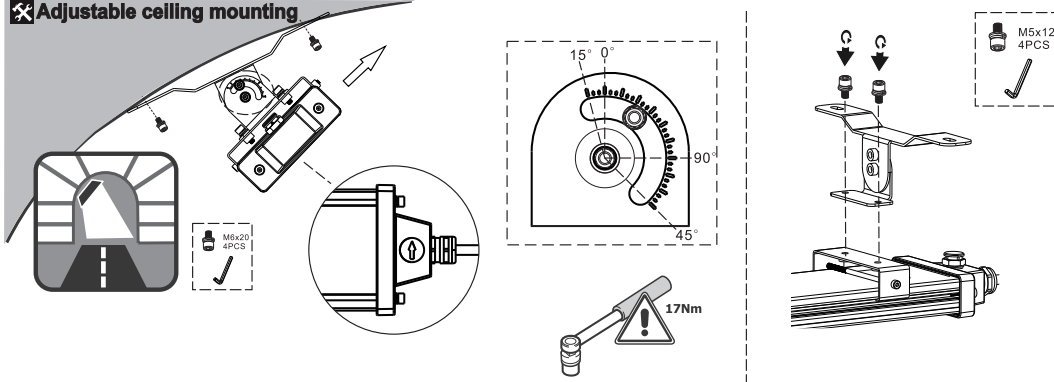

Ceiling mounting

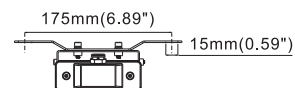
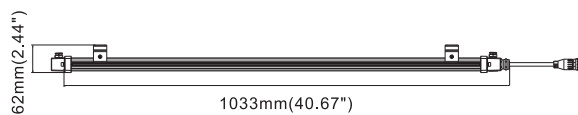
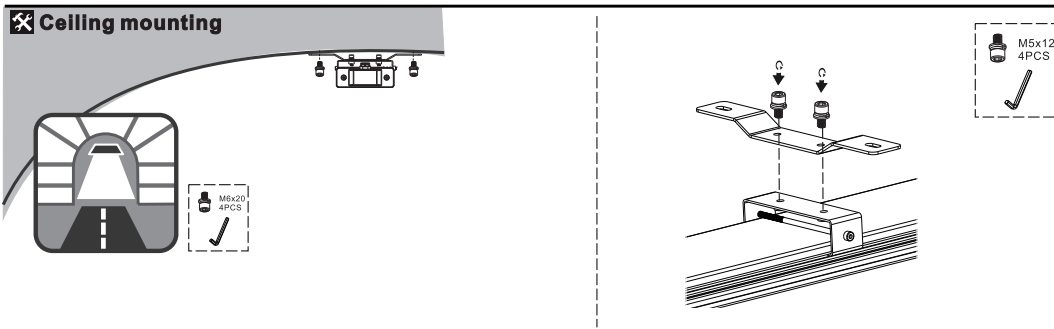

Hook mounting

GxF: Upon request (standard 100x75mm/200x75mm/300x75mm)

G(mm/in)	F(mm/in)
100(3.94")	75(2.95")
200(7.87")	75(2.95")
300(11.81")	75(2.95")

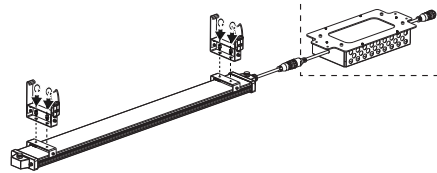
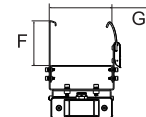
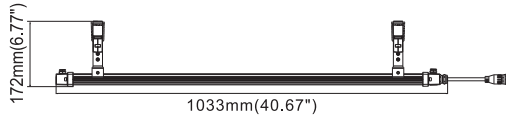
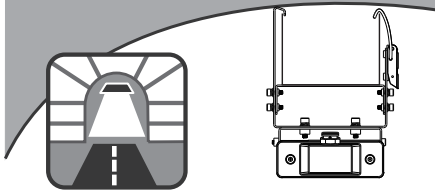

Driver box not supplied by the seller, here only for installation demonstration

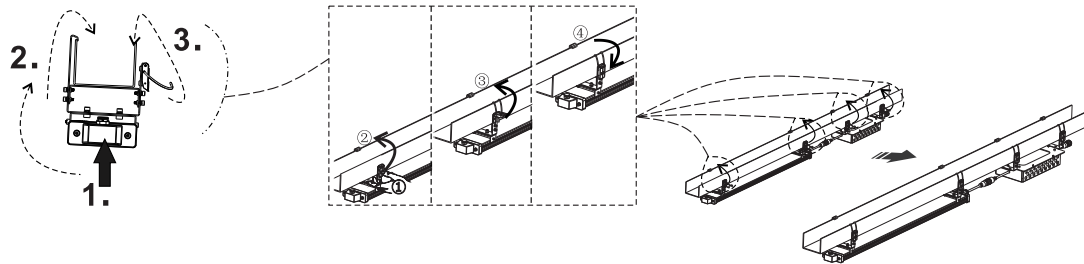

System cabling

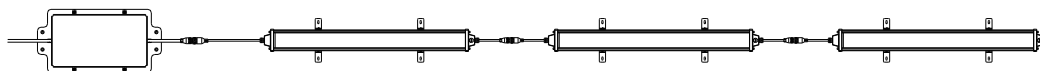

1. The max input current for such system cabling is 8A.
2. Please make sure all lights are well connected before switching on the power.

Wiring method

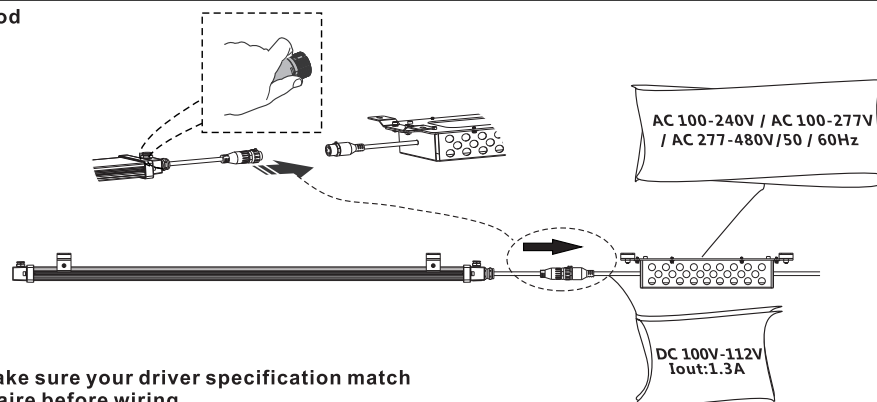

Please make sure your driver specification match the luminaire before wiring.