

# ROMUS USER MANUAL

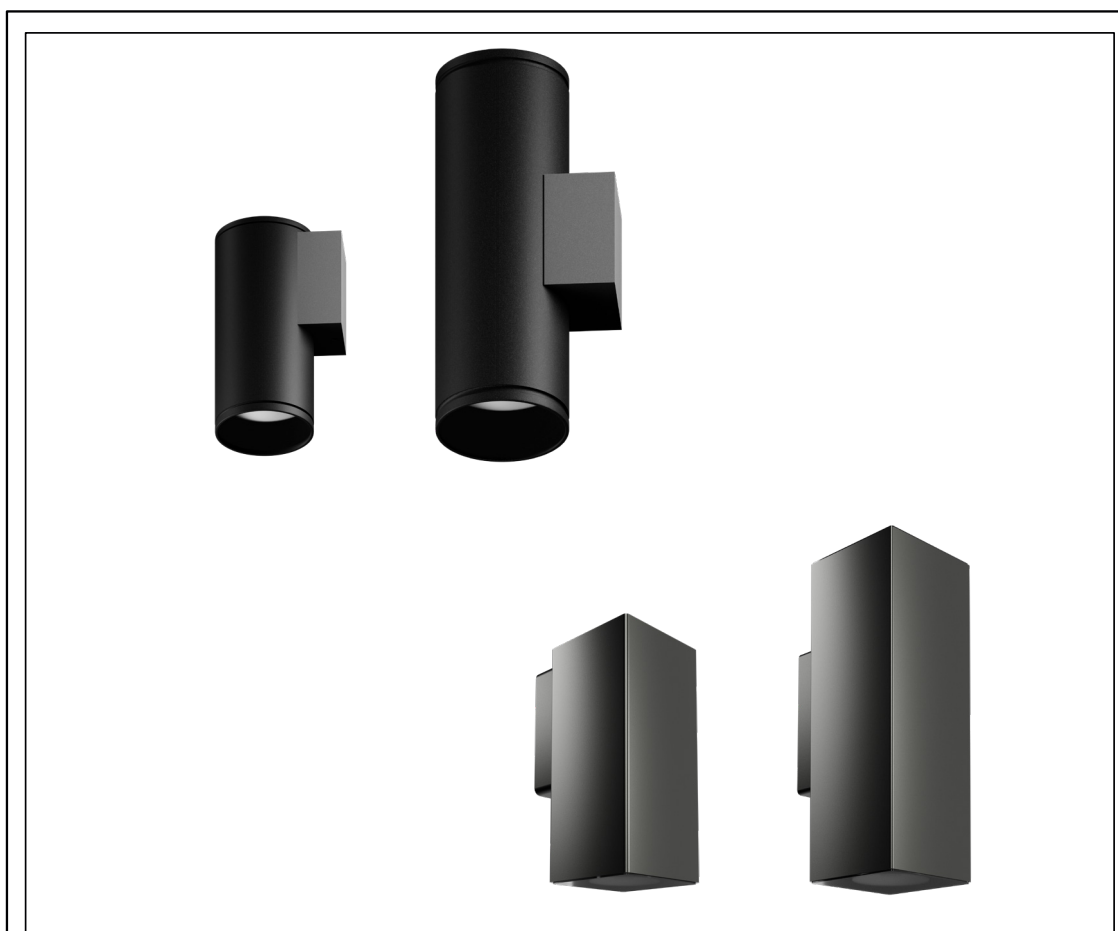

1. The luminaire shall be installed by a qualified electrician and wired in accordance with the latest IEE electrical regulations or the national requirements.
2. No supplied water-proof box, installation should be advised by qualified professional.
3. The external flexible cable can not be replaced. If the cable is damaged, the luminaire should be discarded.

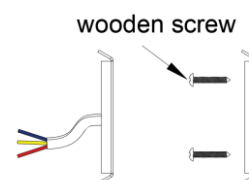
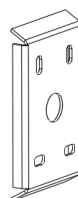
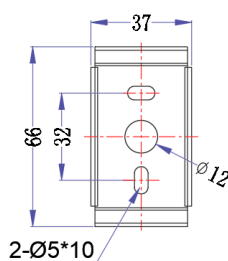
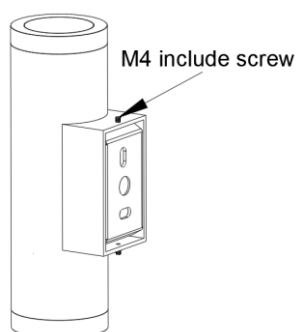
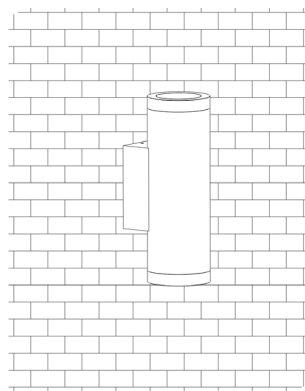

1. Loosen the M5 screws and remove the lamp support.

2. Drill four fixing holes and one threading hole on the wall according to the holes on the support. Insert a rubber plug or wood block into the holes.

3. Pull out a power cord from the wall and pass it through threading hole and then fix the support on the wall with wood screws.

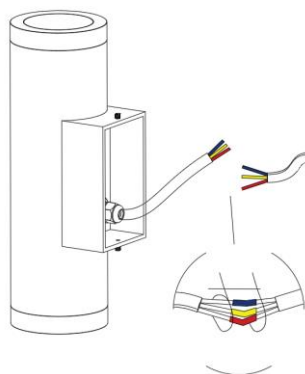

4. Connect power cord to the power cable of the lamps, and then tie it with waterproof tape (waterproof measures must be taken)

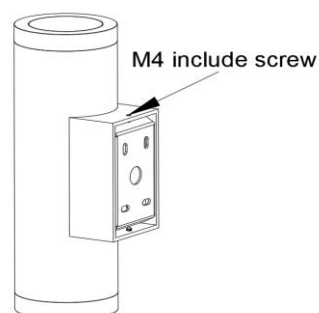

5. Put the long cable in place, Then put the lamp into the support and lock the M4 MI screws.